

# MODELO 3000

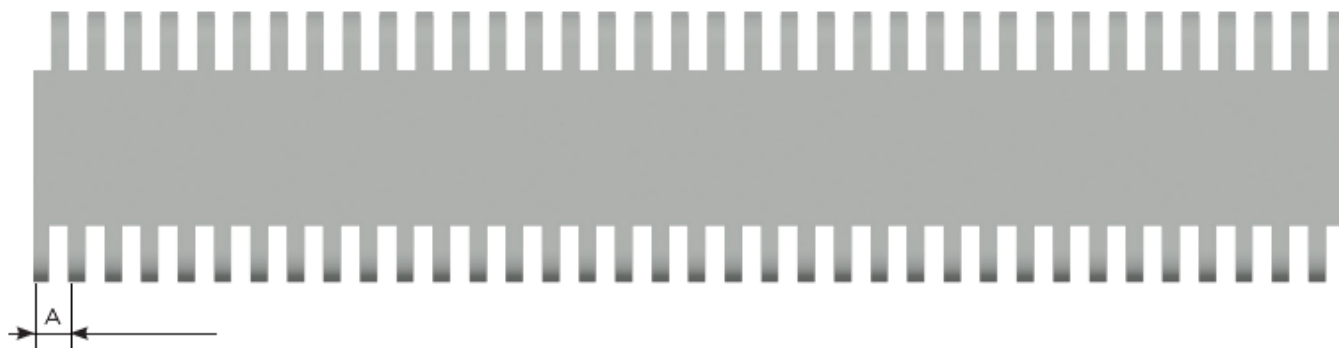

**M3000** - HK50-M-03000 - 0% Apertura



Material	A(mm)
Polipropileno y Polietileno	8,88



**M3300** - HK50-M-03300 - 12% Apertura

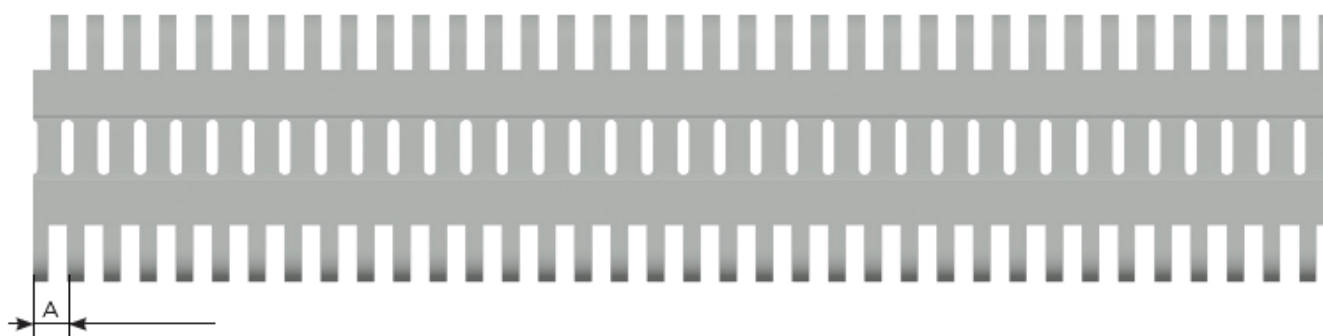

Material	A(mm)
Polipropileno y Polietileno	8,88

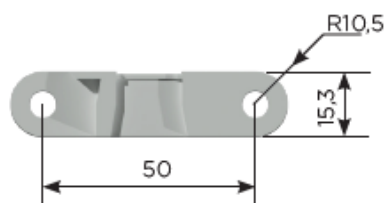



**M3400** - HK50-M-03400 - Material de Caucho Termoplástico

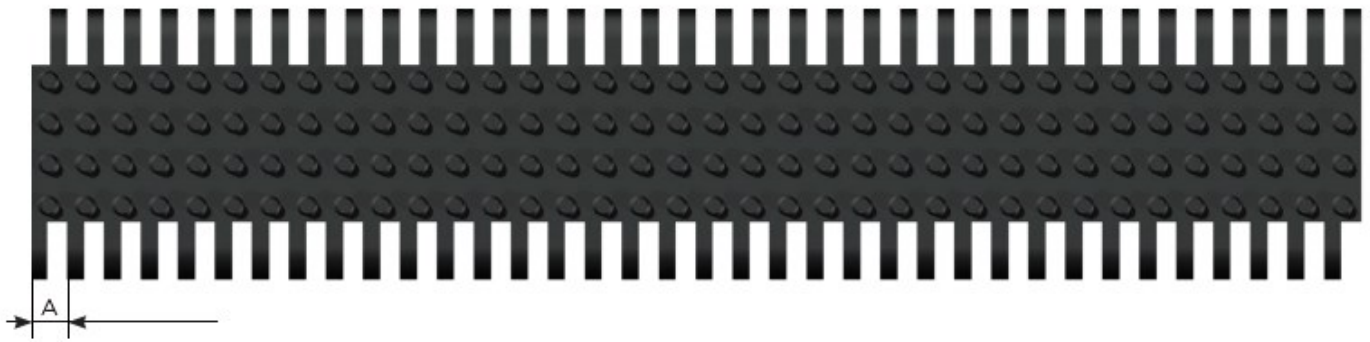

Material	A(mm)
Caucho Termoplástico	8,88

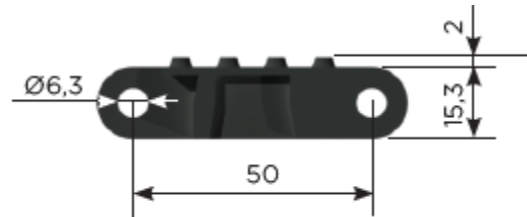

**M3500** - HK50-M-03500 - Material Polipropileno y Polietileno

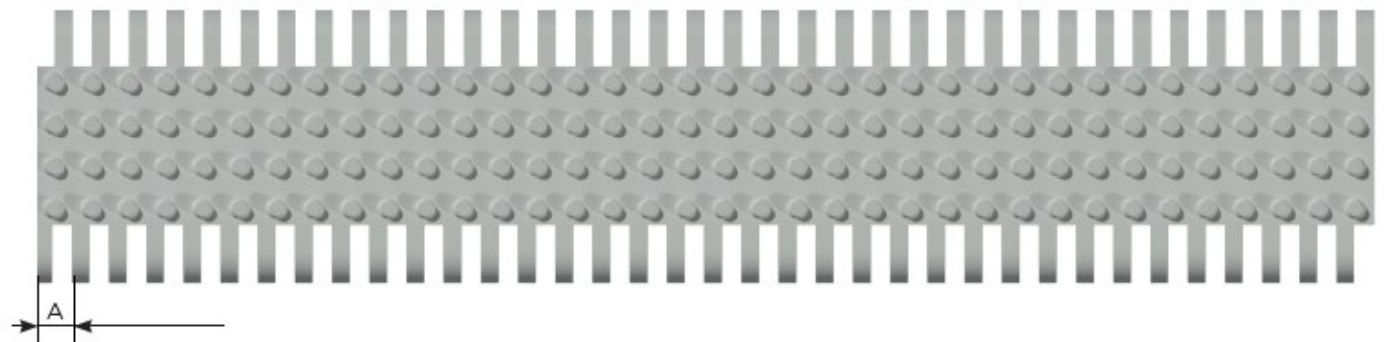

Material	A(mm)
Polipropileno y Polietileno	8,88

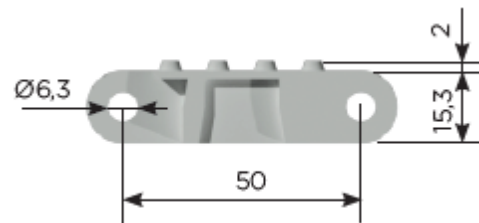

**M3600** - HK50-M-03600 - Material Polipropileno y Polietileno

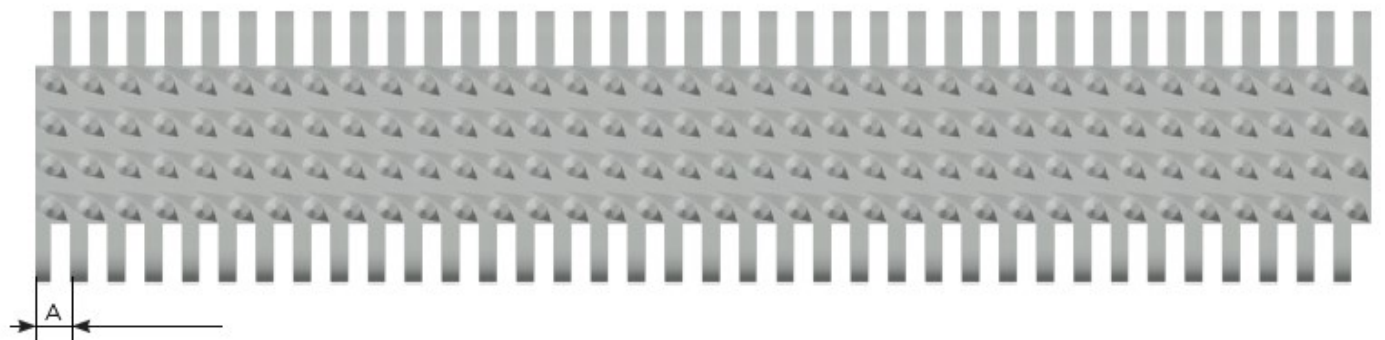

<b>Material</b>	<b>A(mm)</b>
Polipropileno y Polietileno	8,88

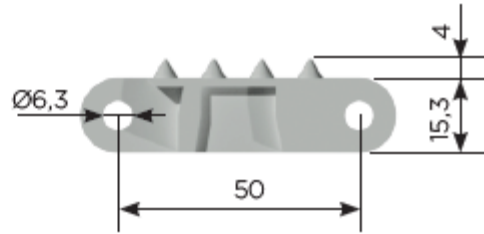

**P3100/ P3200** - 0% Apertura

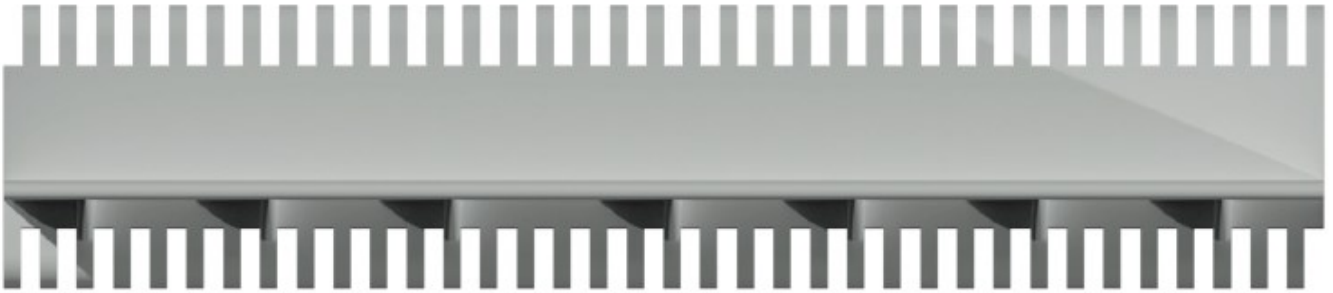

**P3100** - HK50-P-3100

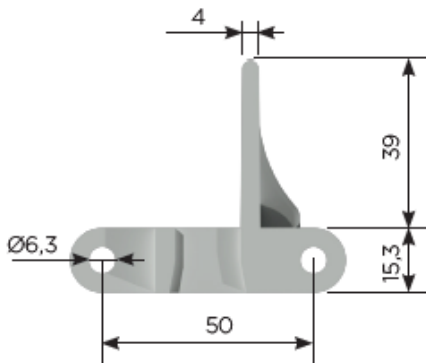

**P3200** - HK50-P-3200

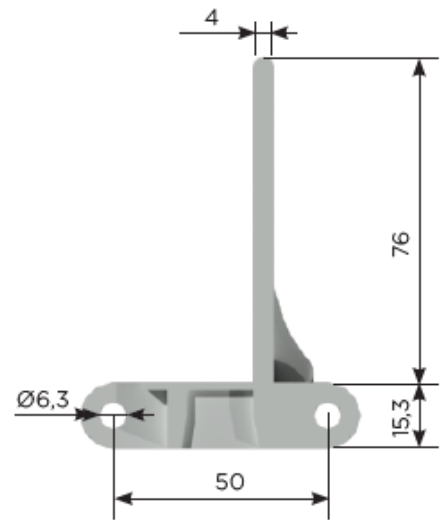

**P3250** - HK50-P-3250 - 0% Apertura - Paleta Doblada

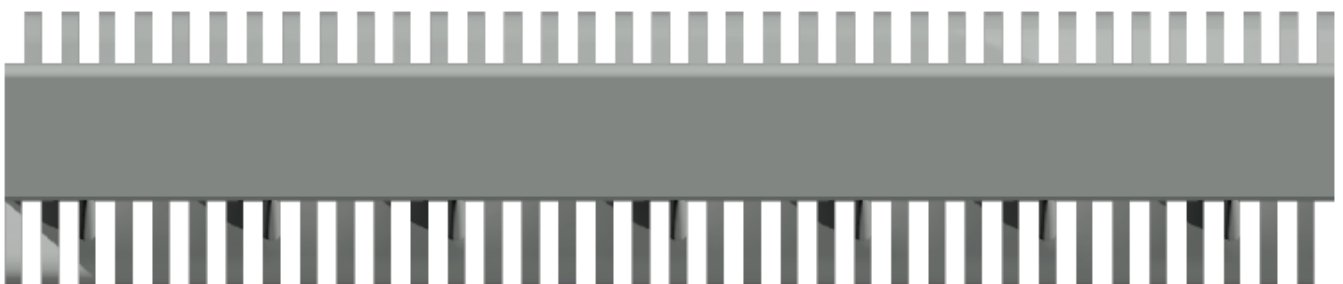

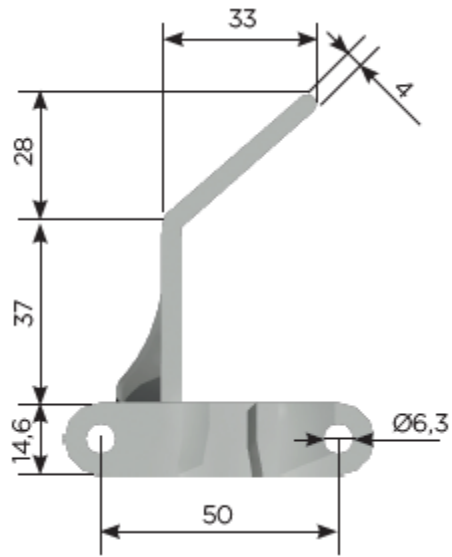

**A174** - HK50-L-00174



**A176** - HK50-L-00176

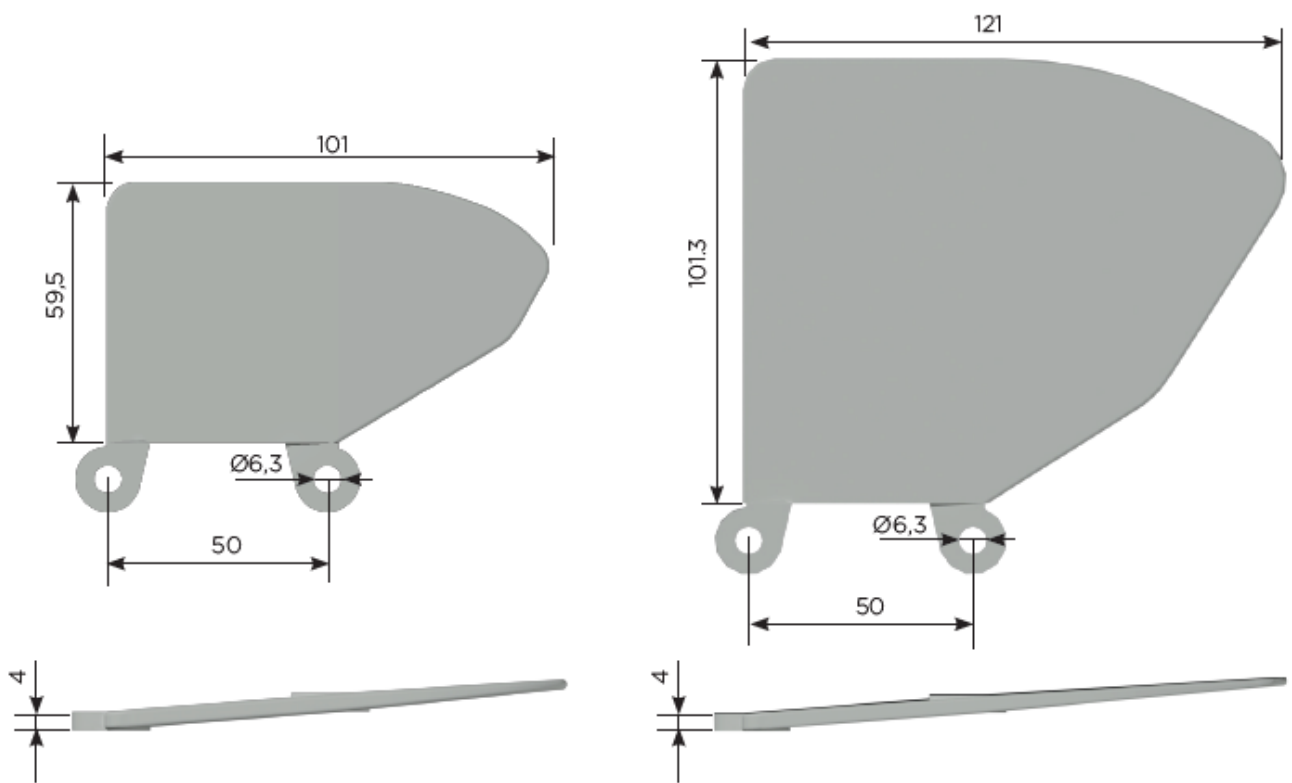



**Z6** - Diámetro primitivo 100 mm

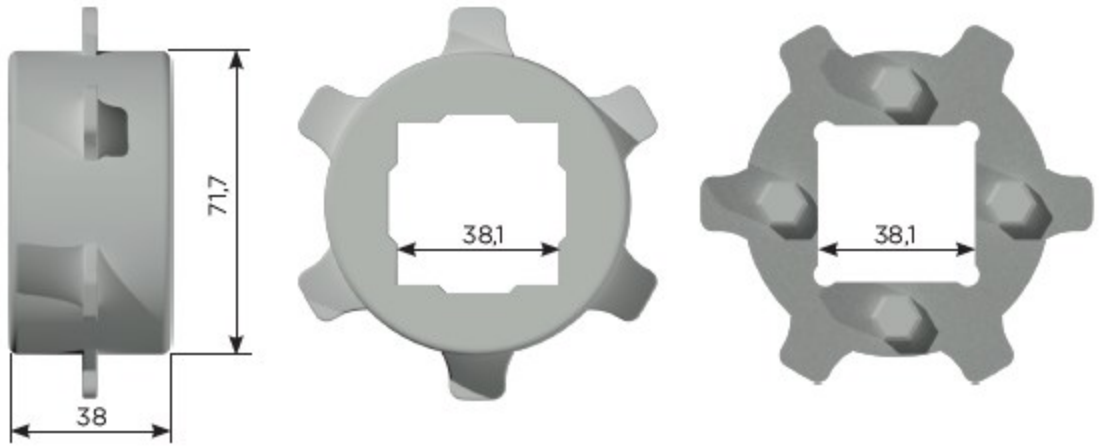

**Z10** - Diámetro primitivo 161 mm

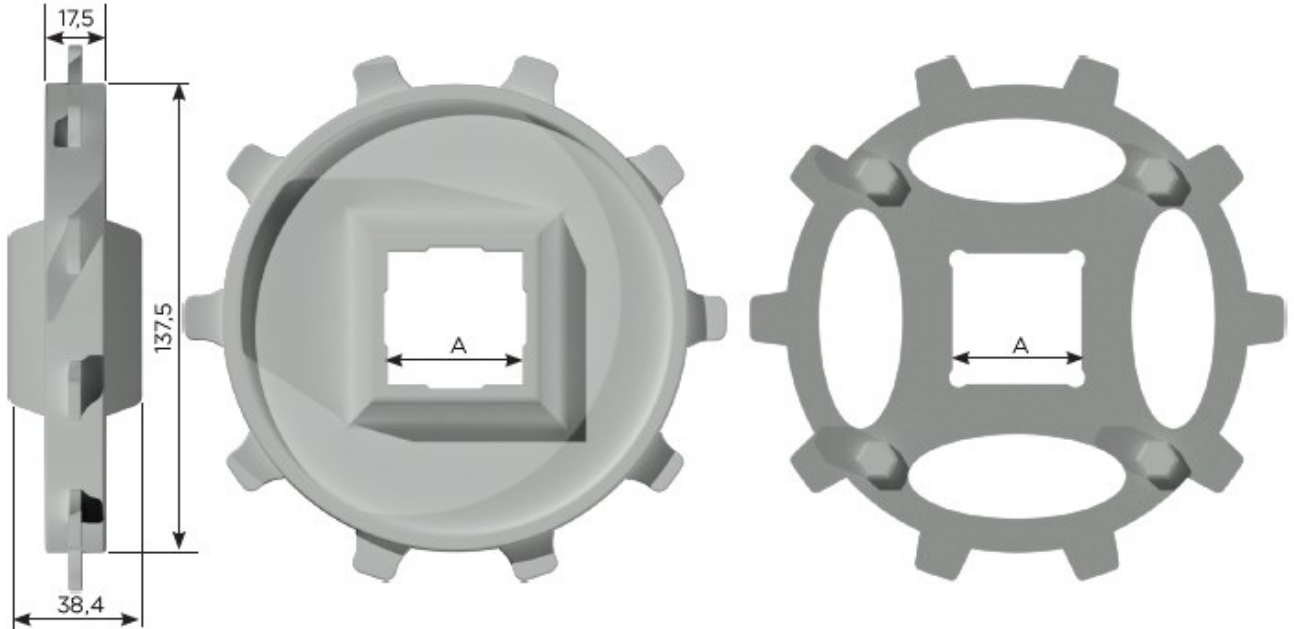



**Z16** - Diámetro primitivo 225 mm

